

▶ REV | MECHANICALS & INSTALLATION DETAILS

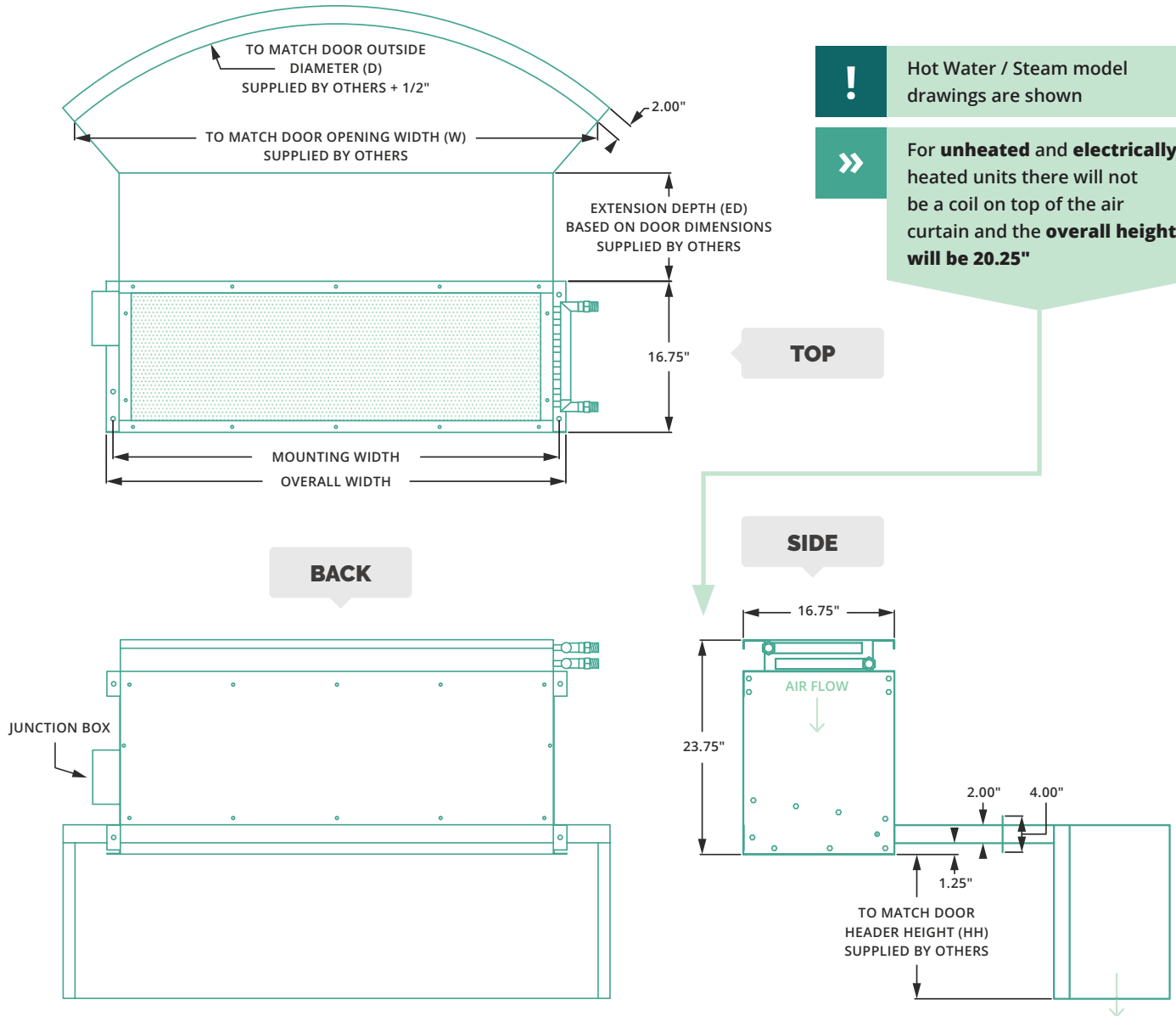

! As the air curtain will be customized per door, instructions will vary for each applications.

Key installation notes to consider are as follows:

- 1** The REV will ship as a single unit but it can be disassembled prior to installation and the air curtain, extension and nozzle can be installed separately and attached on site.
- 2** Note that struts or cross bars may be necessary to provide the proper support for air curtain properly support the air curtain, extension and nozzle.
- 3** Mounting holes will be against the top of the door housing.

