

Installation: Unpacking

Powered Aire's commitment to quality continues after the air curtain is assembled. We package your unit in a sturdy wooden crate and shrink-wrap it for its journey to your site. Please review the following instructions for unpacking your air curtain and preparing it for installation.

STEPS

- 1 Remove shrink-wrap and wood slats from top and side of crate. *Retain the manilla envelope! It contains the O&M.*
- 2 Using a Philips head screwdriver, unscrew the truss head screws that hold intake screen in place. Save screws. Remove intake screen and filter (if supplied).
- 3 The air curtain is bolted to the bottom of the crate frame. Use a 3/8" socket with extension and remove the 4 lag bolts (one in each corner) that attach the air curtain to the skid. Unit is now ready for installation. Lag bolt holes are used to bolt the air curtain to the wall.
- 4 Replace the intake screen and screw in place. (If air curtain is to be mounted flush to the surface, do not replace intake screen until mounting is complete.)

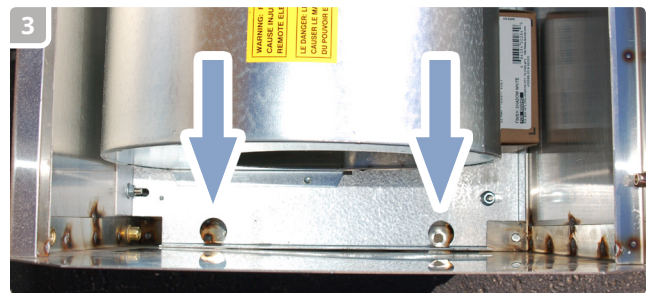
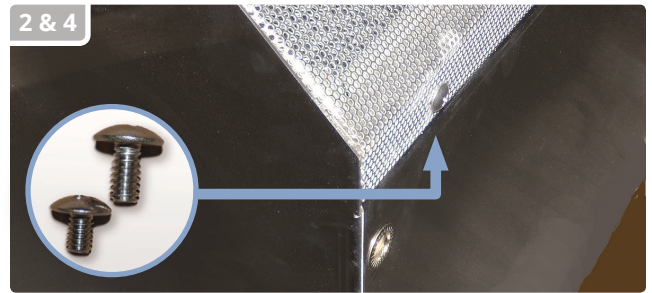
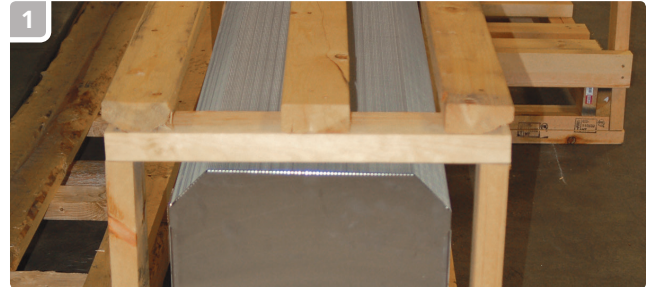

WHERE TO FIND...

If remote controls or switches are supplied with the air curtain they are shipped in one of the following locations:

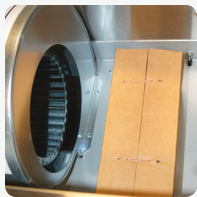

In a box inside the unit.



Inside the junction box.
(Pictured: door activation switch)



Inside the enclosure for industrial units that are supplied with a control panel.



IMPORTANT

- Trained and experienced mechanic / electrician required for installation.
- Powered Aire will not be responsible for misplaced switches.
- When you receive your air curtain, please check for visible or concealed damage. Claims should be made immediately to the transportation company. Powered Aire will not be liable for damage claims submitted late.