

# MB123 Mounting Plate Installation Instructions

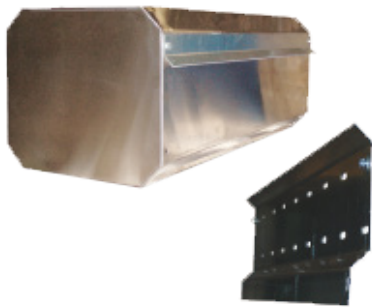

## DIMENSIONS

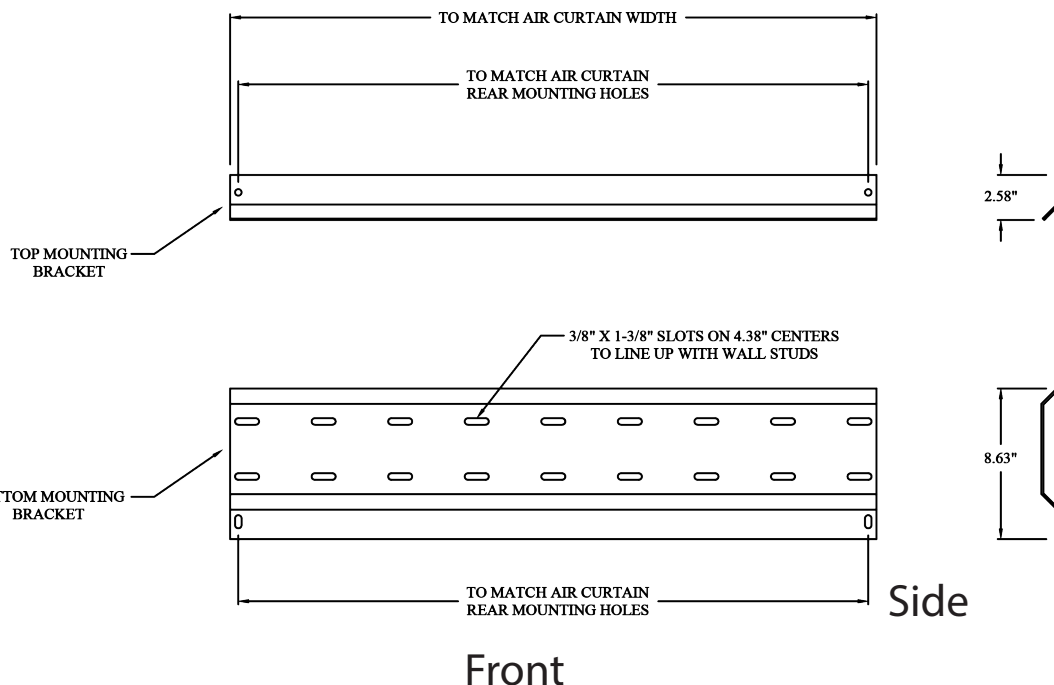

## INSTALLATION

### STEP 1

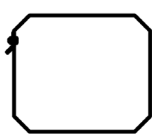

### STEP 2

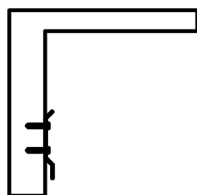

### STEP 3 (A)

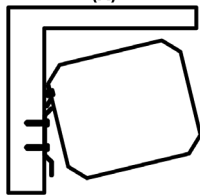

### (B)

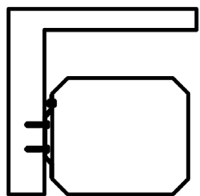

### (C)

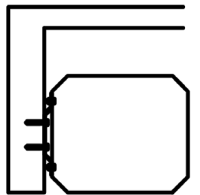

## USAGE

The MB 123 consists of a plate with a universal hole pattern that is attached to the wall and a bar that is attached to the air curtain. The back side of our commercial air curtains have four standard mounting holes. The MB123 can be used when the holes do not line up with wall studs or other structural supports. With this mounting option, the weight of the unit does not have to be supported while the lags are being installed.

## INSTRUCTIONS

**When mounted, bottom of air curtain is to be flush with door header.**

1. Step 1: Attach top mounting bracket to back of air curtain using the top mounting holes on the back of the unit.
2. Step 2: Attach the bottom mounting bracket to the wall. Make sure there is sufficient room between mounting plate and ceiling to mount air curtain.
3. Step 3: Mount Air Curtain
  - A. Place air curtain over bottom mounting bracket.
  - B. The top and bottom brackets will lock into place supporting the weight of the air curtain.
  - C. Attach the bottom bracket to the air curtain using the lower mounting holes.

**QUESTIONS & TECHNICAL SUPPORT AVAILABLE. CONTACT US DIRECTLY:**

Phone Support  
1-888-321-Aire (2473)

Email Support & Service  
[CustomerService@PoweredAire.com](mailto:CustomerService@PoweredAire.com)

Sales Questions  
[Sales@PoweredAire.com](mailto:Sales@PoweredAire.com)