



REV



REV-E



REV-HW



REV-ST

REV



The REV air curtain is designed specifically for revolving door applications to provide additional levels of environmental separation. The REV features a customizable nozzle that can fit the diameter of most revolving doors. The nozzle attaches to an air curtain that operates in the header area above the revolving door and the entire unit remains out of sight while providing all of the benefits of an air curtain. The REV is available with several heating options and can serve as a source of supplemental heat in lobby areas. The custom design of each unit ensures that it can blend seamlessly into a building's aesthetics while creating an effective barrier to block insects, dust, exhaust and outside air from entering.



OPTIONS

HEATING

- Electric
- Hot Water
- Steam

AT A GLANCE

Single Incremental Widths

3' to 12'

Max Installation Height

11'

Heavy Duty Motors

1/2 HP

KEY DESIGN FEATURES

- Stainless steel air curtain, galvanized extension and nozzle that can be customized to fit aesthetics of door
- Custom-built for individual revolving door. Can be color-matched to door or the interior colors of building
- Nozzle creates highly efficient plenum that maximizes distribution of air across entire opening
- Designed to fit in overhead space of revolving door (dependent on available space)
- Air curtain can be set to work in tandem with operation of door or run continuously, which is ideal in for heated units that can provide supplemental heat in areas with frigid temperatures
- Can be used on manual and automatic revolving doors
- Heavy duty 1/2 HP motors. 1075 rpm each. 50/60 cycle
- All units are direct drive, which avoids misalignment of couplers and outboard bearings and eliminates belt replacement

RECOMMENDED CONTROLS

- Continuous operation recommended
- Magnetic door switch for activation
 - Dry contacts to interlock with door controller



► REV-HW & REV-ST | PERFORMANCE

REV-HW | Performance Table

Model	Air Curtain Discharge Width (in.)	Door Opening Width Range (in.)	Max. FPM at Nozzle	Avg. FPM @ Air Curtain Discharge*	CFM at Nozzle	Outlet Velocity Uniformity	Number of Motors	Motor HP	Hot Water		Air Curtain Weight (lbs)**
									MBTU/ Hour	Temp. Rise (°F)	
REV-1-36HW	36	54 up to 66	5560	1205	892	88%	1	1/2	33	34	123
REV-1-48HW	48	66 up to 78	4628	1131	1108	89%	1	1/2	40	33	134
REV-1-60HW	60	78 up to 90	5096	998	1227	79%	1	1/2	48	36	170
REV-2-72HW	72	90 up to 102	5560	1205	1784	88%	2	1/2	66	34	240
REV-2-84HW	84	102 up to 114	5305	1209	2080	90%	2	1/2	78	34	271
REV-2-96HW	96	114 up to 126	4628	1131	2216	89%	2	1/2	86	35	295
REV-3-108HW	108	126 up to 138	5560	1205	2676	88%	3	1/2	102	35	355
REV-3-120HW	120	138 up to 150	5028	1176	2892	88%	3	1/2	112	35	396
REV-3-132HW	132	150 up to 162	4996	1111	3011	79%	3	1/2	119	36	459
REV-4-144HW	144	162 up to 174	5560	1205	3658	88%	4	1/2	138	35	480

REV-ST | Performance Table

Model	Air Curtain Discharge Width (in.)	Door Opening Width Range (in.)	Max. FPM at Nozzle	Avg. FPM @ Air Curtain Discharge*	CFM at Nozzle	Outlet Velocity Uniformity	Number of Motors	Motor HP	Steam		Air Curtain Weight (lbs)**
									MBTU/ Hour	Temp. Rise (°F)	
REV-1-36ST	36	54 up to 66	5560	1205	892	88%	1	1/2	32	33	123
REV-1-48ST	48	66 up to 78	4628	1131	1108	89%	1	1/2	41	34	134
REV-1-60ST	60	78 up to 90	5096	998	1227	79%	1	1/2	49	36	170
REV-2-72ST	72	90 up to 102	5560	1205	1784	88%	2	1/2	65	34	240
REV-2-84ST	84	102 up to 114	5305	1209	2080	90%	2	1/2	76	34	271
REV-2-96ST	96	114 up to 126	4628	1131	2216	89%	2	1/2	84	35	295
REV-3-108ST	108	126 up to 138	5560	1205	2676	88%	3	1/2	98	34	355
REV-3-120ST	120	138 up to 150	5028	1176	2892	88%	3	1/2	107	34	396
REV-3-132ST	132	150 up to 162	4996	1111	3011	79%	3	1/2	115	35	459
REV-4-144ST	144	162 up to 174	5560	1205	3658	88%	4	1/2	131	34	480

*As nozzles are custom per unit, the actual FPM leaving the nozzle will vary per application.

**Air curtain only. Weight will increase with addition of extension and nozzle and will depend on the dimensions of the custom nozzle.

REV HW/ST | Sound Levels

High Speed	63 dBA	Low Speed	56 dBA	Measured 10 ft. from unit in a free field based on a 1 motor unit
-------------------	--------	------------------	--------	---

REV HW/ST | Amp Draw and Breaker Options

Model/Number of Motors	120V Amp Draw (Breaker size)	208-230V Amp Draw (Breaker size)	480V Amp Draw (Breaker size)	575V Amp Draw (Breaker size)
REV-HWST-1-36, 42, 48, 60	8.0A (15)	3.6A (15)	2.0A (15)	1.5A (15)
REV-HWST-2-72, 84, 96	16.0A (25)	7.2A (15)	4.0A (15)	3.0A (15)
REV-HWST-3-108, 120, 132	24.0A (35)	10.8A (15)	6.0A (15)	4.5A (15)
REV-HWST-4-144	32.0A (45)	14.4A (20)	8.0A (15)	6.0A (15)

▶ REV | MECHANICALS & INSTALLATION DETAILS

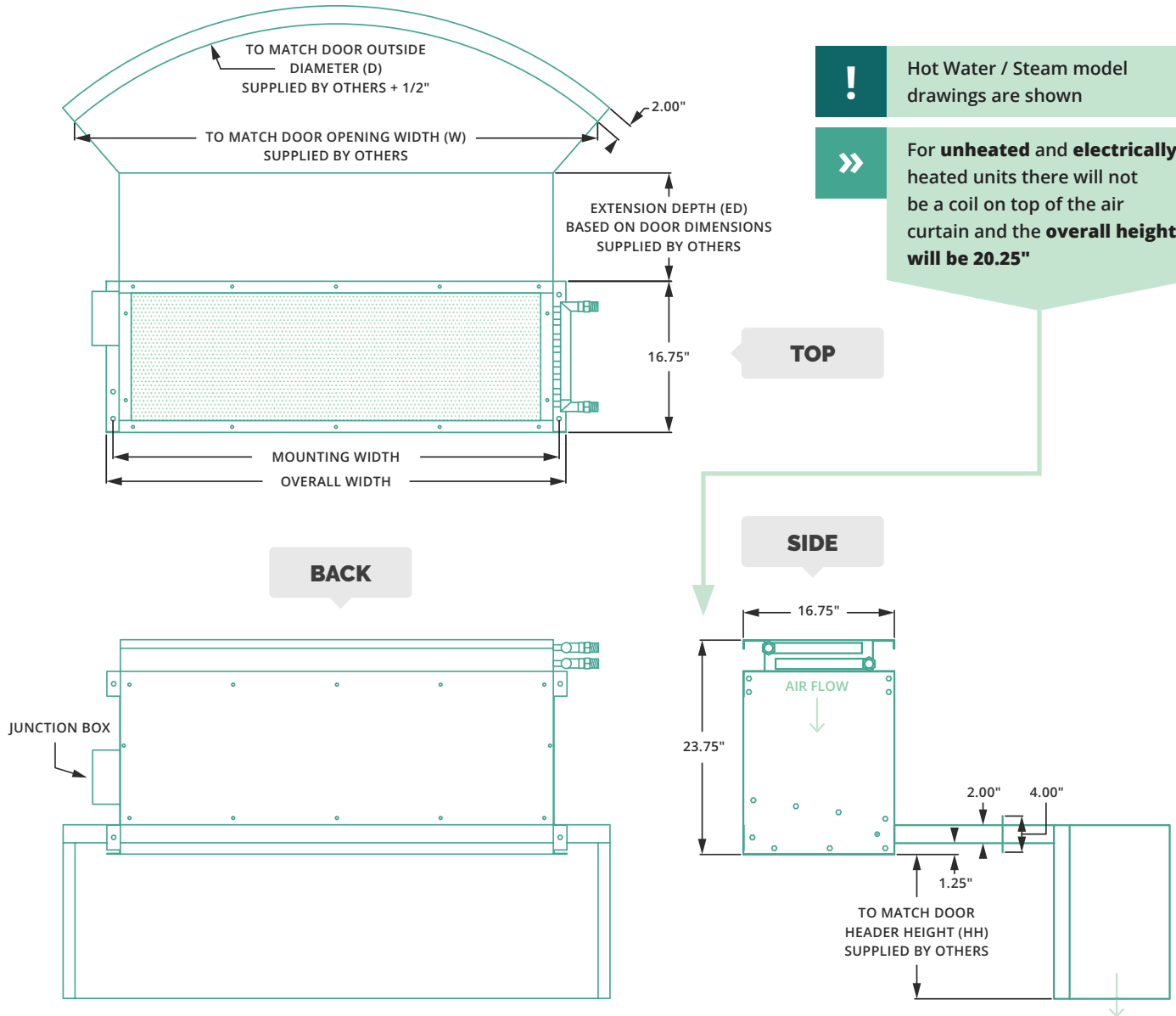

Hot Water / Steam model drawings are shown



For **unheated** and **electrically heated** units there will not be a coil on top of the air curtain and the **overall height will be 20.25"**



As the air curtain will be customized per door, instructions will vary for each applications.

Key installation notes to consider are as follows:

- 1 The REV will ship as a single unit but it can be disassembled prior to installation and the air curtain, extension and nozzle can be installed separately and attached on site.
- 2 Note that struts or cross bars may be necessary to provide the proper support for air curtain properly support the air curtain, extension and nozzle.
- 3 Mounting holes will be against the top of the door housing.

